

Inferum LLC
Ekaterinburg, Russia

**Operating and Service Instruction Manual
Hardware-software complex ROFES E01C
for functional and emotional state testing
EN**

ROFES E01C RU стр. 3
ROFES E01C DE seit. 101
ROFES E01C CZ pag. 151

INFE 01.00–03.73–01 PЭ

Congratulations on your purchase of your ROFES E01C!

In order to help you learn how to handle the appliance effectively and safely please carefully read all the sections of this manual.

Introduction This Operating Manual of hardware-software complex ROFES E01C shall be regarded as an integral part of the device.

User manual for hardware-software device ROFES E01C is a part of product. Please read user manual for ROFES E01C carefully before using.

CONTENTS

INTRODUCTION	57
1. SAFETY INSTRUCTIONS AND MAINTENANCE	60
2. THE PURPOSE	63
3. PRODUCT DESCRIPTIONS	65
4. TECHNICAL SPECIFICATIONS	66
5. SETTING ELEMENTS	68
6. INFORMATION ABOUT THE METHOD	70
7. CONTRAINDICATIONS FOR USE	79
8. OPERATING PROCEDURE	80
9. FUNCTIONS OF MOBILE APPLICATION «ROFES-E01C»	90

10. MAINTENANCE	93
11. DISPOSAL	94
12. TROUBLE SHOOTING	95
13. MANUFACTURER'S WARRANTY	97
WARRANTY CERTIFICATE	198
CERTIFICATE OF COMPLIANCE	202

INTRODUCTION

A Mobile «phone» for communication with your body

Up-to-date technologies provide us with fantastic opportunities. We can receive information in a matter of seconds, being remote for thousand of kilometers from the scene. We are able to see, hear and even to participate in the events. However, we are still poorly informed about what is going on inside of our own body. We lack any technical device to communicate with it immediately.

How can we constantly receive the information on the processes occurring in our body so that we could know its trouble spots and prevent the development of dangerous changes? Such devices are generated by space medicine today and they are intended for an assessment of cosmonauts' health level. One of such recently developed devices is a ROFES E01C device for testing the level of your health. It is a small device that works jointly with a mobile communication device. It can be called a mobile «phone» for communication with your body.

What sort of information can we get with its help? The device tests a functional condition of 17 major organs and systems, enabling us to see, how their work is affected by different loads: physical, stressful, connected with malnutrition, bad habits, sharp change in the weather, environmental problems, etc. The program shows, how the whole organism

and its every organ react and adjust to this influence. If the organism does not get adapted to loadings, the risk of diseases grows. In this case, the program helps to reveal the trouble spots, a predisposition of organs to disease and future risk assessments at present. It enables us to be aware of organism's strength reserve.

Regular testing allows us to see in dynamics the working process of separate organs and of the whole body. The assessment of psycho-emotional state shows the influence of emotions on the work of the body. The testing results are displayed in easy and clear five-point evaluate system and marked out by appropriate colors.

All the information can be found in comments on assessments. It is easy to understand to any person and does not demand special medical knowledge. The device is convenient and simple in use. The indications are taken from a point on the hand. To begin testing it is just enough to start up the program and press one button on the device.

The time has come to listen to your body and set ourselves on a positive course, especially now when we are given such opportunities! We have ceased to write each other letters. We use the Internet and cellular communication. So it has come in the field of health to pass to new technologies.

Here is the decision. ROFES E01C device is your mobile «phone» for communication with your body.

WARNING!

ROFES E01C is not intended for self-diagnosing or confirming clinical diagnosis, as well as for prevention, treatment and rehabilitation of diseases, medical research, rehabilitation, and replacement, changes in anatomical structure or physiological functions of the body. The purpose of the device is to control the changes in the functional state of the body and to work out the future disease risks in consequence of repeated dysfunctions. Early detection of risks results in preventive care-seeking.

1. SAFETY INSTRUCTIONS AND MAINTENANCE

EN

1.1. Read all the information regarding your safety carefully as well as recommendations on the cleaning and maintenance of ROFES E01C

1.2. The complex is intended for taking data from biologically active point P-7 (Daling) which is commonly located at the wrist crease of the left hand (see section 8.4.5).

1.3. Differences between scores on the test and scores on the retest should be due solely to the processes occurring within the body (eating, taking medicine, etc.) and its exposure to external influence (physical activity, stress). It is not the consequence of device malfunction.

1.4. In order to avoid high-frequency disturbances that may lead to inaccuracy in testing and probable malfunction of the device do not connect the user to any high-frequency equipment while testing.

1.5. ROFES E01C contains fragile items. Protect against shocks.

1.6. ROFES E01C is not waterproof. Protect from moisture.

1.7. As with all electronic devices, keep the device out of the reach of children unless they have been given supervision or instruction concerning use of the appliance by a person responsible for their safety.

1.8. Do not let the product come into contact with rain, moisture or other liquids. Keep it away from heaters; avoid prolonged exposure to direct sunlight at high (over 35 °C) temperatures.

1.9. This appliance is not intended for use by persons with reduced physical, sensory or mental capabilities.

1.10 The special software for ROFES E01C is intended to work conjunctively with mobile devices running the operational system **Android version not less than 4.2.**

1.11. In order to avoid possible injuries to your body or to the appliance, do not attempt any repairs by yourself. Such work should be carried out by qualified service personnel.

1.12. The device is not applicable for testing pets. The technology is designed only for human body!

1.13. Use only for its intended purpose as described in this manual.

1.14. **Transportation conditions:** temperature from -50 °C to +50 °C, relative humidity from 30 % to 93 %, atmospheric pressure of 70 kPa to 106 kPa. The device should only be transported in a closed vehicle.

1.15. **Storage conditions:** Packed appliances should be stored indoors at ambient temperatures from -40 °C to +50 °C and relative humidity of 80 % (upper value) at plus 25 °C.

1.16. **Operating conditions:** temperature from +10 °C to +35 °C, relative humidity from 30 % to 93 %, atmospheric pressure of 70 kPa to 106 kPa.

WARNING!

If the device has been stored at an ambient temperature below 10 °C, keep it boxed for three hours at room temperature to avoid condensation.

2. THE PURPOSE

Hardware-software complex ROFES E01C is designed to test the overall level of health and functional status of 17 major organs and body systems, to identify their adaptive resources and predict the signs of dysfunction developing, as well as assessment of a mental and emotional state of a person. This enables the user to take sufficiently early actions to maintain and protect their health.

Hardware-software complex ROFES E01C is not intended for self-diagnosing or confirming clinical diagnosis, as well as for prevention, treatment and rehabilitation of diseases, medical research, rehabilitation, and replacement, changes in anatomical structure or physiological functions of the body. The purpose of the device is to control the changes in the functional state of the body and to work out the future disease risks in consequence of repeated dysfunctions. Early detection of risks results in preventive care-seeking.

The assessment of mental and emotional state indicates the level of fatigue, stress and nervous tension, and enables you to see the influence of emotions on the work of your body.

Special training to operate ROFES E01C is not required.



Compliance with standards: this device is CE marked in accordance with Directive 2006/95/EC LVD Low voltage products and Directive 2004/108/EC Electromagnetic compatibility.

3. PRODUCT DESCRIPTIONS

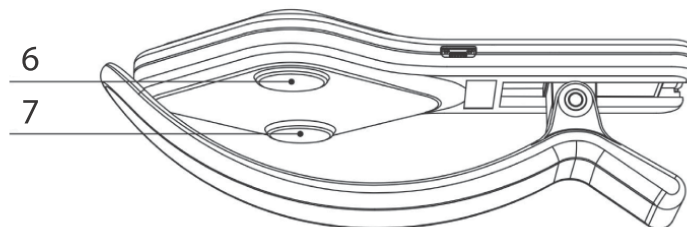
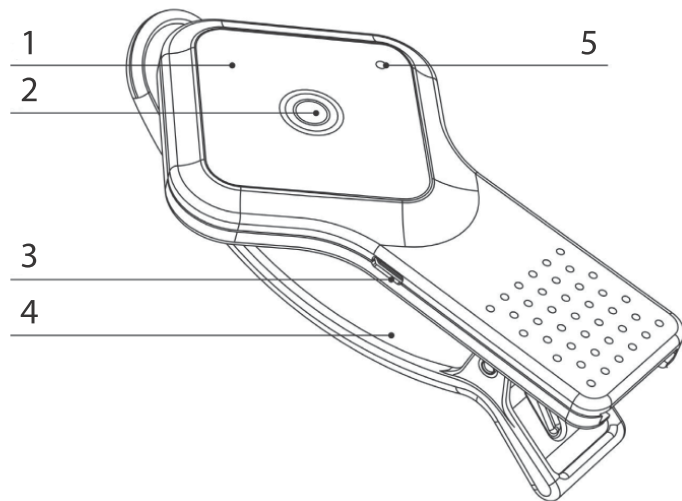

Fig.1 ROFES E01C measuring unit

1. Body of the device
2. «Start» button
3. MicroUSB connector to connect the interface cable from the measuring unit to a mobile device
4. Clip
5. Status LED
6. Passive electrode
7. Active electrode

4. TECHNICAL SPECIFICATIONS

EN

4.1. Main technical specification

Parameter	Value
Max. current consumption	150 mA
Power USB	5 B
Size, max.	140x70x40 mm
Weight, max.	0,1 kg
Power source	USB-connection
Degree of protection against electric current	III
Protection against ingress of water	IP 30

4.2. Signs on the cover:



4.3. On the body cover of ROFES E01C is a label with the product name, producer's address, warning signs indicate the maximum values of voltage and electric current:



5. SETTING ELEMENTS

EN

Items	Quantity
Measuring unit ROFES E01C	1 pc.
User's manual	1 pc.
Case	1 pc.
MicroUSB-microUSB (see section 5.1) cable to connect to the mobile device (see section 5.2), (see section 5.3)	1 pc.
Cosmetic tissues (see section 5.4)	1 pack

5.1. The manufacturer's warranty does not cover the cable products.

5.2. If you need to connect ROFES E01C to mobile devices, instead of a microUSB-microUSB cable, you may use OTG-microUSB cable (supplied separately) in conjunction with a USB-microUSB cable.

5.3 The special software for ROFES is intended to work conjunctively with mobile devices running the operational system **Android version not less than 4.2.**

5.4. You may use cosmetic tissues from other manufacturers, different from those supplied.

WARNING!

When choosing cosmetic tissues make sure they are not alcohol-based, fragrance free and not impregnated with cream!

6. INFORMATION ABOUT THE METHOD

The method is based on stimulating the biologically active point P-7 (Daling) on the inner side of your left hand wrist by passing an electrical micro current impulse through it to all the organs causing a respond reaction. Every organ of a human body operates in its own strictly defined, proper rhythm. The responses from the rhythms, like an echo, get back to the device and later they are compared with reference ranges for a healthy person of corresponding sex and age in the program.

The result of data testing is presented in four assessments:

- overall level of health status;
- functional state of organs and systems;
- energy resources of organs and systems that determine their adaptive responses to various load;
- psycho-emotional state.

6.1. Overall level of health status

Overall health status is an ability of the whole body to adapt to environmental changes. It is defined as a general energetic resource needful to ensure the operation of mechanisms of self-regulation.

Rates and corresponding level of health and analysis of condition are shown in Table 1.

Table 1

Color assessment of the overall level of health	Current health status rate	Analysis of the condition
5	High	High energy resource ensuring the work of mechanism of self-regulation
4	Well above average	Border-line rate, closer to high energy resource, guaranteeing the work of self-regulation mechanism
3	About average	An average energy resource providing the work of self-regulation mechanism
2	Well below average	Border-line rate, closer to low energy resource

Color assessment of
the overall level of health

1

Current health
status rate

Low

Analysis of the condition

Exhaustion of energy resources, organism's adaptive resources are depleted. May cause in break up in adaptation to the factors of the environment.

6.2. Functional state of organs and systems

Functional state of tested organs and systems shows the degree of their tension at the moment.

Due to external factors or depending on the state of the organ or system different reactions of your body are possible (the levels of activation):

- lack of tension, when there is not much effort is required to respond;
- slight tension under experiencing insignificant external influence;
- average tension when experiencing short external influence without causing significant damage, an organ or a system is able to compensate the influence;
- strong tension, when significant influence is experienced;
- depression, when an organ or a system cannot perform the functional load in full by itself;
- overstrain (distress) when the organ or system is highly tensed.

Assessments, functional conditions of organs or systems and activation levels are given in Table 2.

Table 2

Functional state of the system/organ, color rate	Rate of the functional state of the organ/system	Level of activation
5	Excellent	No tension
4	Good	Weak tension
3	Satisfactory	Medium tension
2	Unsatisfactory	Strong tension, depression
1	Critical	Overstrain

6.3. Energy Resources of organs and systems

Body energy resource characterizes the level of stored energy of tested organs or systems, providing adaptive reactions.

The low level of the body energy resource, defining reduced adaptive response, gives precautionary indications for raising risk of developing a condition for dysfunction and in case of their stable repetition shows the risk of incidence of an illness.

The assessment of the level of body energy resources and systems, loads and the risks of disease and comments on them are shown in Table 3.

Table 3

Color assessment	Comments
5	High energy resource of the organ, optimum load. Risk of developing disease is minimal or it's a compensated process.
4	Good energy resource of the organ, minor load. Risk of developing disease is low or it's a compensated process.
3	Decrease in energy potential of the organ, which is a consequence of its loading. Risk of the incidence of an illness is medium.

Color assessment	Comments
2	There is a loss of energy resource of the organ observed, which a consequence of excessive loading is. Risk of an illness tends to rise with a long stay in this state.
1	There is a big loss of energy resource of the organ, which is a consequence of an overloading, which may result in high risk of incidence of an illness if the organism remains in this stage for a prolonged period of time.

WARNING!

If the rates «2» and «1» are repeated and predominate within several tests successively, the predisposition to malfunctions and thereby occurrence of risk of diseases is increased. However it is possible to confirm or disprove any sign of raised risk of developing a disease only after have taken three or more tests according to the results of tendency analysis. When the steady tendency to recurrent dysfunction goes on, it is recommended to visit a doctor.

WARNING!

The system may not assess your likelihood of developing the signs of risk and the conditions of disease development, if you have a chronic process in the stage of compensation or, if it is a result of medication or other therapeutic interference. In these cases, the device will show the status of organs and systems, taking into account the impact they are exposed to.

6.4. Psycho-emotional state

The testing enables to reveal the following conditions:

- stress state (compensatory forces of the body are depleted);
- signs of fatigue (internal emotional stress);
- sign of neurosis, and irritability.

These conditions may or may not occur. An estimation of these states and commentaries are given in Table 4.

Table 4

Color rating of the state	Comments
5	This state is not detected
4	This state is weakly detected
3	This state is weakly detected
2	This state is highly detected
1	This state is highly detected

6.5. Additional Features

ROFES E01C enables you to see how one or another effect influences the processes occurring in your body – a body's response. It is necessary to perform the test immediately before the impact, and the next test should be performed no sooner than 20 minutes after the impact commencement. If the impact is a long-term one (sports training, massage, therapeutic procedure), then testing should be done immediately after the end of exposure to it. Testing can be performed with several tests running with a test interval multiple of 20 minutes. In this case make sure to control that the influence experienced doesn't involve any additional loads, which will distort the result.

It is also possible to see the effects of the biologically active additives (BAA) on your body. To do this, the test should be performed immediately before taking BAA, and the next test is not earlier than 20 minutes after intake. To see the maximum effect it is necessary to continue testing with the multiplicity of 20 minutes. Each additive has its individual time of effect, which also depends on the time of reception, dosage and other factors.

7. CONTRAINDICATIONS FOR USE

- Intolerance on plastic components and metal electrodes of the measuring unit contacting with skin;
- intolerance on a short-time effect of micro current;
- irritated skin on the place of the contact with the electrodes;
- the presence of malignant diseases;
- if you are using cardiac pacemaker;
- pregnancy.

8. OPERATING PROCEDURE

8.1. Prior first use

Hardware-software complex ROFES E01C is intended for use with people of all age groups who watch over their own and their relatives' and friends' health.

No special testing conditions needed.

Testing can be carried out at any convenient time for the user.

During the testing, the user can take any comfortable position. However, make sure to perform all the actions specified in paragraph «The testing procedure».

8.2. How often you can use ROFES E01C

The frequency of test running is determined by the user as often as it is required, having regard to previous overall health state rate (Tab.1).

The users with:

- a high level of health state should implement the device not less than once every 10 days;
- a good level of health state should implement the device not less than once every 5 days;
- a satisfactory level of health, the test is carried out daily;
- unsatisfactory level of health, the testing is recommended at least 2 times a day, in the morning and in the evening;

- under the age of forty, the testing is recommended at least once a week, over forty years – at least once every three days;
- for the people working under stress conditions, testing is recommended at least 2 times a day, in the morning and in the evening;
- for the people who are actively involved in sports or work under conditions of extreme physical exertion and manual labor, the test is recommended at least 2 times a day – in the morning and in the evening.

8.3. Installation and connection

8.3.1. Installing the software on your mobile communication device.

Download the application called «ROFES-E01C» from the server play market for Android.

WARNING!

The software for ROFES E01C is intended to work jointly with mobile communication devices running the operational system **Android, not less than 4.2 version.**

8.3.2. To log in you should fill in the registry with the required information: your name, sex and the date of birth, as well as the password to login to your user account and an e-mail address for the password recovery (the password is optional).

WARNING!

When registering, specify your sex and the date of birth correctly. These characteristics are important for testing and estimation accuracy.

8.3.3. When restarting the testing process, select your account in the «User switching» or add a new user, by clicking on the «New User», following the paragraph 8.3.2.

WARNING!

The number of users implementing the device ROFES E01C is limited to 5 people.

8.4. The testing procedure

8.4.1. Connect the device to your mobile device via microUSB-microUSB cable. To do this, insert the microUSB cable connector into microUSB-port of the mobile communication device, microUSB-connector insert into the USB-port of ROFES device (Fig. 2). The green light signal starts flashing on the ROFES E01C device.

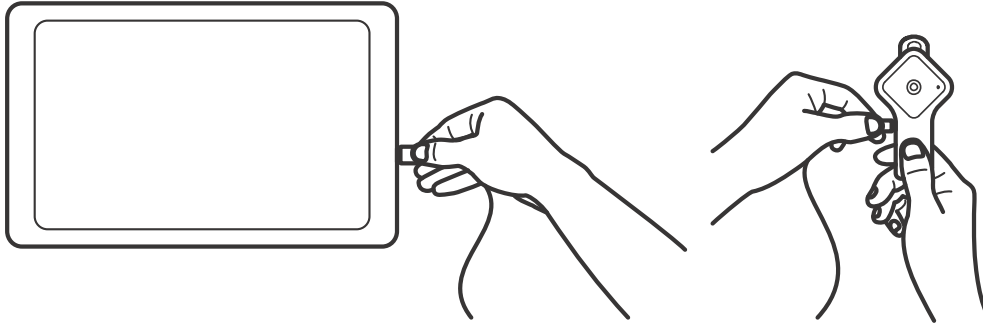

Fig. 2

8.4.2. To conduct the test firstly select the personal data line from the list of users registered in the program.

8.4.3. Sit down on the chair or the armchair or on the couch. Relax, take off your watches or bracelets from the left wrist and turn back the clothes' sleeve, if necessary (Fig. 3).

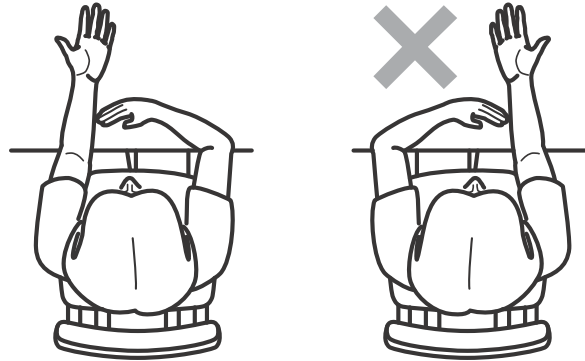

Fig. 3

8.4.4. Wipe with damp cosmetic tissue the inner surface of the wrist in the place of the contact with the electrode and the electrodes of the measuring unit, as shown in Fig. 4.

EN

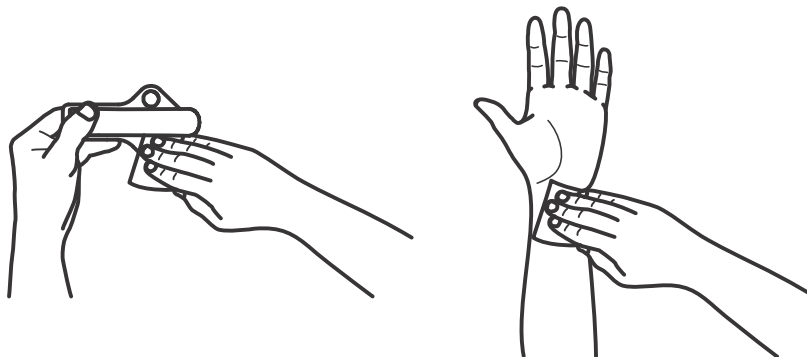

Fig. 4

WARNING!

The time lag between wiping your wrist and starting the test should not exceed 4-6 sec. Test results will be invalid if these actions have not been fulfilled.

8.4.5. Holding your left hand, palm up, place the device on the wrist. Biologically active points (BAP) on the left hand wrist should be aligned with the active electrode of the diagnostic unit (Fig. 1). BAP is in the middle of the fold line of the hand (Fig. 5).

WARNING!

«Biologically active point» or BAP is a point on your skin which exhibits special physiological properties distinguishing it from surrounding skin surface area. Particularly, these points demonstrate a higher level of skin conductance. The conductance of BAP will depend on physiological and psychological states at a moment in time. This property of BAP is used in testing.

BAP is easy to find. Bend your left hand at the wrist. Put your right thumb right in the middle of the formed fold between the hand and the forearm. Unbend your arm without lifting the finger. The finger will stand at the point where the active electrode of the device is adjusted (Fig. 5).

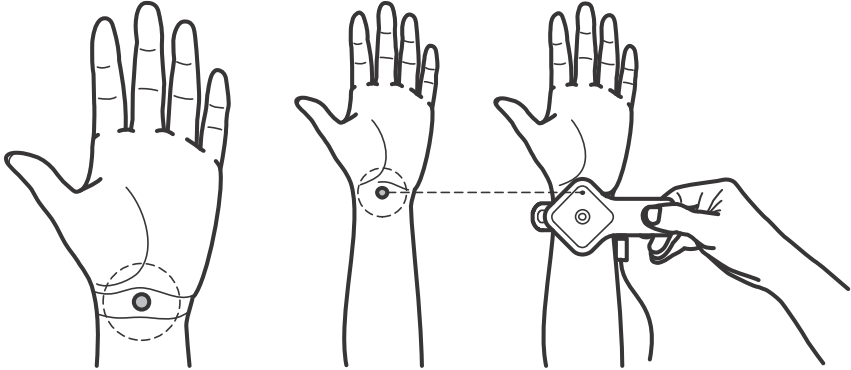

Fig. 5

8.4.6. After 4-5 flashing LED signals click «Start» button on the device for 0.5-1 seconds, or «START» button in the panel of the mobile application. Do not move during the whole testing procedure, don't remove your hand with the unit attached and remain still fixed as long as the mobile device display lights up the message informing about the successful completion of testing.

WARNING!

In case of non-specified action on these items, the test results will be invalid!

WARNING!

If the test was carried out improperly, the information about the incorrect test procedure will appear on the display of your mobile communication device. Wait for 15 seconds and repeat the test on the scheme above (considering all the necessary actions to get prepared for the test), but perform it not more than three times. In case of three unsuccessful y made attempts, repeat the testing in 20 minutes. If thereafter you still receive the message mentioned above, contact the technical support service, please.

8.4.7. If the test is completed successfully, wait for the test results on the display. The results are automatically stored in the program «ROFES-E01C» on your mobile communication device.

8.4.8. Take off the device.

8.4.9. Get to know your test results.

8.4.10. Unplug microUSB-microUSB cable from microUSB-port of the mobile communication device and from microUSB-port of the ROFES E01C device. Close the program by clicking the Exit button. Put the cable and the device into the case.

WARNING!

It is recommended regularly (at least once a week) to clean the electrodes with cleaning cloth. It is important to store the device with its electrodes dry.

9. FUNCTIONS OF MOBILE APPLICATION «ROFES-E01C»

EN

WARNING!

The functional capabilities of the program «ROFES-E01C» are described in details in the «Help» section of the mobile application.

Basic functions of mobile application «ROFES-E01C» enable to:

9.1. Have all the test results submitted in the form of graphs, representing the information about the state of an organ / a system at a preset time interval, that is: the graph of overall functional state of the body, the graph of the functional state of an organ or a system, the graph of risks of developing disease of the organ or a system.

When choosing «Psycho emotional data» the graphs show all the three assessments of mental and emotional states (stress, emotional stress and the sign of neurosis).

9.2. See the results of any previously performed testing. The test result is presented in five-point ratings form. The calendar for the week makes it convenient to see the number of testing results conducted on any of the days.

9.3. Enables you to compare the results of up to 7 tests, taken at different times. You need to select the results from the calendar and add them to comparison. You will see a comparison of the results represented in 2 columns, where the left column shows the estimated

functional state and the right one shows the risk assessment.

9.4. You can take notes and make comments on each of the test result, i.e. you can comment on the overall state of you health (or make any other record) at the time of testing. This option enables you to keep a diary of test results and to record external or internal factors that affect your body.

9.5. Automatic forwarding of the test results to e-mail address (es). In the «Settings» section, add the address (es) to automatic forward of emails. Tick the address (es) for forwarding. **Please note that you are sending off important personal information.** After you have ticked the address (es) for an automatic forward of test results, the results of each test made will be forwarded to the addresses listed, if provided with the Internet connection.

WARNING!

This option is possible when configured for your mobile device Internet connection. In the absence of Internet connection, the last ten test results will be sent immediately after you connect the mobile device to the Internet

9.6. Set a reminder for follow-up tests. In the «Settings» section, click on the «Create a reminder». In the reminder menu, select the time and the day to remind you of test performing. If necessary, set a name, such as «Morning test».

9.7. Deleting results. Improperly conducted test can be removed immediately afterwards in the «Results» section and so in the «Analytics», if there is a need to delete previously taken test results. To do this, click «Delete test» in the «Results» section or in the bookmark «Journal» of «Analytics» section and confirm the deletion.

WARNING!

The software designer takes the right to bring in a change into the software to improve user specifications.

10. MAINTENANCE

EN

Maintenance must be set as follows:

- Visual inspection of the product. Make sure that the device is undamaged and detects no signs of evidence of shock because it can lead to its further incorrect running.
- Before starting the device as well as after using it, it is necessary to clean up the electrodes of the measuring unit. To clean the electrodes use nonaggressive disinfectants (e.g., soapy water or a weak solution of chlorhexidine) and a soft lint-free cloth. Inadequate cleaning may cause allergic reactions or lead to skin infection when the device is shared by several users.
- The check for function is carried out on the working program «ROFES-E01C» by switching on the device.

WARNING!

Do not use alcohol-based solutions to clean the electrodes!

11. DISPOSAL

EN



All packaging materials are not harmful to the environment, they can be reused. After the end of its working life the device does not present any potential hazardous effect on environment, human life and health.



Appropriate waste handling of electronic equipment.

WARNING!

Waste equipment is not completely unnecessary waste! The device contains valuable materials which can be used repeatedly after utilization with consideration of requirements of environmental protection. They shall be delivered to specially intended for this purpose places (consult with corresponding services in your district) for collection and processing.

12. TROUBLE SHOOTING

Table 5 shows the problems which you can solve independently. In case there are other problems occurred, please contact the manufacturer's representative. Do not attempt any repairs by yourself!

Table 5

Problem issue	Solution
<p>No connection with the measuring unit A message on the screen: «Exit the program». Connect the testing devise. Enter the program. Start testing.</p>	<ul style="list-style-type: none"> • check the USB cable connection • if the cable is connected, disconnect and replace it by a similar one • if the problem persists, contact the service center
<p>No signal from LED.</p>	<ul style="list-style-type: none"> • check the USB cable connection • if the cable is connected, disconnect and change it to a similar one • if the problem persists, contact the service center

Problem issue	Solution
LED display is lit only by a single color.	<ul style="list-style-type: none">• Contact the service center
After pressing the button the testing doesn't start.	<ul style="list-style-type: none">• Contact the service center
While testing a person 3 times successively appears the message: Improper testing procedure, there are artifacts.	Carry out the testing the other person, if the situation persists, then contact the service center
<p>WARNING! All others works on maintenance and repair of the device must be executed by qualified specialists of the manufacturer or service center of the manufacturer.</p>	

13. MANUFACTURER'S WARRANTY

13.1. The service life of the product is 5 years. If the operating instructions are followed properly, the lifetime of the device can exceed the officially established term.

13.2. This product is warranted for the period of 24 months from the original date of purchase.

13.3. The manufacturer or the manufacturer's authorized dealers exclude all liability and responsibility to the customer for any damage occurred after purchase, resulting from:

- mishandling, improper transportation, failure to follow operating and maintenance instructions provided by this manual;
- third party activities;
- force majeure.

13.4. The warranty does not apply to products which have had their warranty seals damaged or removed.

13.5. If, within the warranty period, the product is determined to be defective or incomplete, please send your claims to the manufacturer (use the post address) or the dealer you purchased the product from. Deliver the item back, including a repair request report, with your name, surname, address and telephone number.

Enclose a note explaining the symptom or difficulties observed with the product's performance.

Manufacturer's address:

Inferum LLC,
620026, Russia, Ekaterinburg,
86-487, Belinskogo street

Postal address:

620100, Russia, Ekaterinburg,
Sibirsky Tract 12, b. 1, of.206
Tel. / Fax: +7 (343) 247-84-51
E-mail: info@inferum.ru
www.inferum.ru

For product related complains contact our official representative in EU countries.

The official representative in EU countries address:

CARLAINE LLC

VAT: CZ 26400731

360 05, Czech Republic, Karlovy Vary,
U koupaliště 844/12

Postal address:

360 17, Czech Republic, Karlovy Vary,
Rybářská 839/2

Tel.: + (420) 774 404 111

E-mail: info@rofes.eu

www.rofes.eu